

PERFORMANCE SPECIFICATION FOR BATTERY TYPE FGC 23505

Nominal Voltage	12 Volts
Nominal Capacity	20 hour rate @ 1.75 A 25°C 35 Ah
	5 hour rate @ 5.6 A 28 Ah
	1 hour rate @ 21 A 21 Ah
	1 C @ 35 A 17.5 Ah
Dimensions (LxWxH, mm)	198 x 132 x 170, TH 170
Approximate weight	12.7 Kg
Energy Density	94.53 Wh/l
Specific Energy	27.94 Wh/kg
Internal Resistance (Fully charged battery)	8 mΩ
Max discharge current in 1 min discharge	210 A
Max discharge current in 5 sec discharge	320 A
Recommended charging voltage (@20°C)	floating use: 13,5-13,8 Vcyclic use: 14,4-15,0 V
Thermal compensation factor	floating use: -18mV/°C cyclic use: -30mV/°C
Maximum charging current	10.5 A
Terminals	Threaded inserted M5
Torques	4Nm
Vibration Test	
(2000 cycles/min, 2,55 mm excursion, 2 hrs)	No loss in capacity or performance
Shelf life (% of nominal capacity at 20°C)	1 Month 97%
	3 months 91%
	6 months 83%
Storage temperature	-20°C to 40°C
Operative temperature range	Charge 0° C to 40°C
	Discharge -20°C to 50°C
Case material	Acrylonitrile-Butadiene-Styrene
	Standard Case: according to UL-94 HB
	Also available: according to UL-94 VO
Life expectancy (cyclic use)	more than 500 cycles at 50% depth of discharge

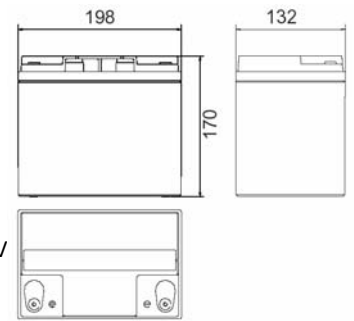

Battery dimensions (mm)

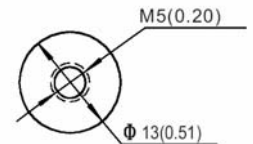

Terminal type

CONSTANT POWER DISCHARGE TABLE (WATT)

TIME	5'	10'	15'	20'	30'	45'	1h	2h	3h	5h	10h	20h
1,8V/Cell	159	123	104	89.6	69.1	50.6	41.5	23	16.7	11	6.37	3.45
1,75V/Cell	175	131	109	90.5	69.8	51.2	42.1	23.9	17.4	11.4	6.37	3.5
1,7V/Cell	187	142	114	94,9	72.3	51.9	42.8	24.5	17.9	11.7	6.41	3.5
1,67V/Cell	195	147	116	96	73.2	52.3	43.1	24.8	18	12	6.44	3.54
1,6V/Cell	208	152	118	97.5	73.7	53.1	43.4	25.2	18.3	12.2	6.48	3.57

CONSTANT CURRENT DISCHARGE TABLE (AMPERE)

TIME	5'	10'	15'	20'	30'	45'	1h	2h	3h	5h	10h	20h
1,8V/Cell	103	75.3	53.9	46.6	35	27.3	21.4	12.1	8.58	5.53	3.26	1.71
1,75V/Cell	110	79.5	57.1	48.7	36.8	28.2	21.7	12.4	8.86	5.85	3.29	1.75
1,7V/Cell	119	83.7	64.4	50.4	38.2	28.4	22.4	12.6	9	5.95	3.36	1.8
1,67V/Cell	123	85.8	66.2	51.8	38.5	28.8	23.1	13	9.14	6.09	3.43	1.82
1,6V/Cell	129	87.9	67.2	52.9	40.3	29.3	23.5	13.2	9.42	6.23	3.51	1.85

DISCHARGE TIME VS DISCHARGE CURRENT

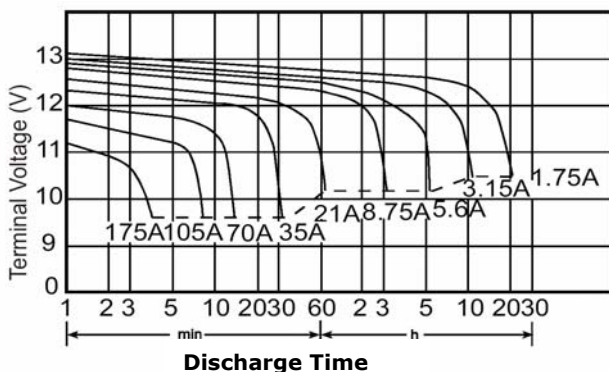

LIFETIME IN CYCLIC USE

