

## SUPER HEAVY DUTY BATTERY

## 4R25X

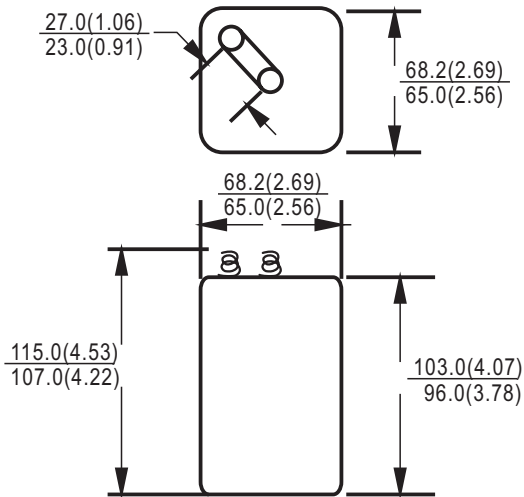

Unit: mm(inch)

**Chemical System :** Zinc /Manganese Dioxide  
(Zinc Chloride Electrolyte)

**Camelion No :** 4R25X

**IEC No. :** 4R25X

**ANSI/NEDA No.:** 908CD

**Average Weight :** 500.0g

**Dimension (Lx W x H) :** 65.0x65.0x96.0 mm

**Terminals:** Spring

**Nominal Voltage :** 6.0Volts

**Operating Temperature:** -30°C ~55°C

**Average Capacity :** 7000 mAh to 3.2 volts  
(20±2°C, Rated capacity at 25 mA continuous drain )

**Shell:** Plastic

**Label :** Paper Label

### Discharge Characteristic

Load Resistance (Ω)	End Point Voltage (V)	Discharge Pattern	Duration
8.2	3.60	30min/day	400min
9.1	3.60	30min/h,8h/day	370min
15.6	3.60	24h/day	700min
110	3.60	12h/day	155hrs

Discharge curves

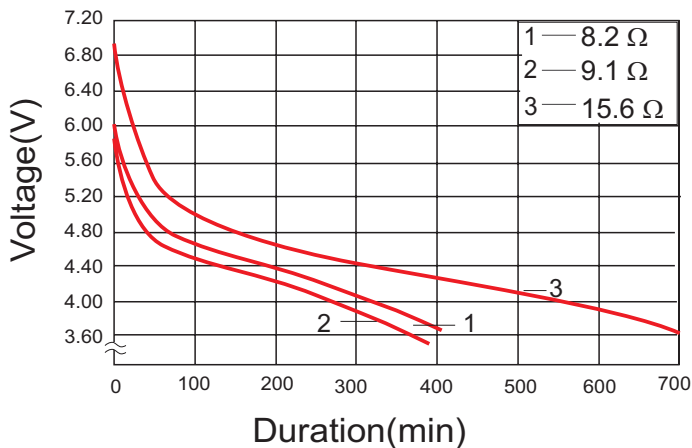

Discharge curve

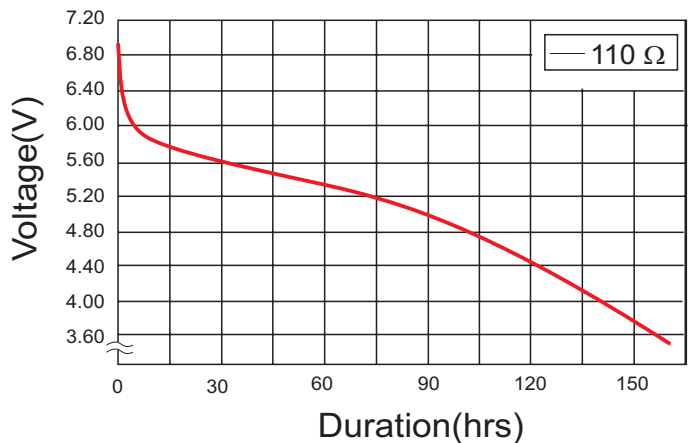

**Notice:**

Environmental elements comply with RoHS requirements. This information is subject to change without prior notice and for reference only. It should not be used as a basis for a product guarantee or warranty. For additional information, please consult your nearest Camelion Sales Office or Distributor or visit our website at: [www.camelionbattery.com](http://www.camelionbattery.com).